

Note that all unique customer requirements (i.e tolerance) need to be verified thru Alfa Laval.

Z31
Alloy 316
S1,S2,S3,S4

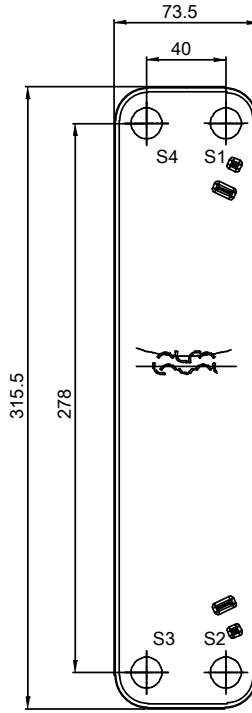

T1 T2 T3 T4 locations on back side correspond to S1 S2 S3 S4 on front side

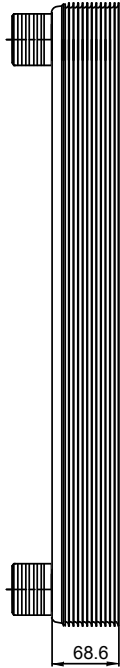
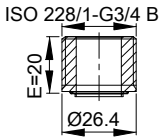
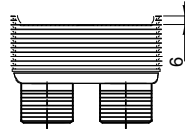

HEATING SURFACE
NETWEIGHT 2.43 kg
OPERATING WEIGHT
PLATE MATERIAL Alloy 316
PLATE GROUPING 1*14AH/1*14AL

ALL DIMENSIONS IN MILLIMETERS

SIDE	MEDIA	INLET	TEMP.	OUTLET	TEMP.	FLOW RATE	PRESSURE DROP	LIQUID VOL.
1								0.48 dm ³
2								0.59 dm ³

PRESSURE VESSEL APPROVAL PED
CBH18-29A (3287095933)

www.alfalaval.com

CUSTOMER NAME / REF. NO.

COMPANY / REF.

TOTAL LENGTH 88.6 mm
TOTAL WIDTH 73.5 mm
TOTAL HEIGHT 315.5 mm

8/24/2017
REV 0