

**FRONT VIEW**

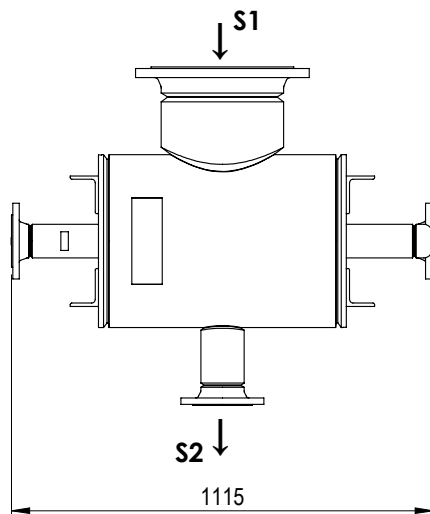

**LEFT VIEW**

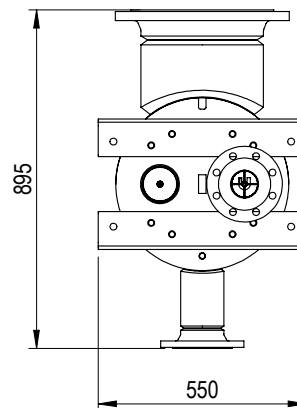

**TOP VIEW**

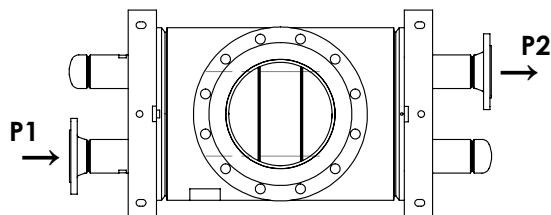

Note : Hydrostatic tests will be performed with liners installed, no pressure retaining welds will be leak tested before liners are installed

**CONNECTIONS**

NAME	DN/NPS	PN / Class	SERVICE
S1	DN300	PN16	Shell Inlet
S2	DN100	PN16	Shell Outlet
P1	DN80	PN16	Plate Inlet
P2	DN80	PN16	Plate Outlet

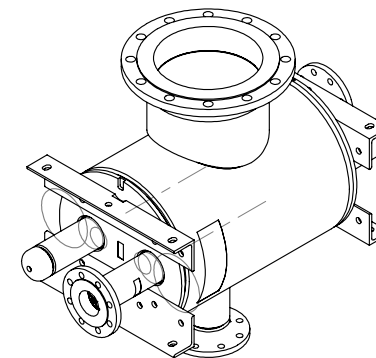

	Shell Side	Plate Side
<b>Design Pressure</b>	5.000 bar	5.000 bar
<b>Max Temperature</b>	250.0 °C	125.0 °C
<b>Min Temperature</b>	0.0 °C	0.0 °C
<b>Plate Material</b>	ALLOY 316 L	
<b>Empty Weight</b>	380.0 kg	

\* Please note that the Design Pressure is considered to be identical to the MAWP.  
Any over-thickness in the calculation note or/and on the 'as-built' exchanger will not be considered in a re-calculation aimed at adjusting the MAWP.

Data, spécification, and other kind of information of technological nature set out in this document and submitted by Alfa Laval to you ("Proprietary Information") are intellectual proprietary rights of Alfa Laval. The Proprietary Information shall remain the exclusive property of Alfa Laval and shall only be used for the purpose of evaluating Alfa Laval's quotation. The Proprietary Information may not, without the written consent of Alfa Laval, be used or copied, reproduced, transmitted or communicated or disclosed in any other way to a third party.

**Item :** DS-M 5 bar steam 40m3 125C

**Setting :** Horizontal

**Sheet scale :** 1:20

**All dimensions are stated in mm**

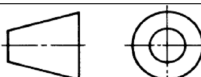

*Heat exchanger DuroShell*

**DS-M**

