

This is a general drawing. Additional parts, if required, like protection sheets, inspection covers, etc. are not displayed.

Designed constructed and stamped in accordance with 2019 ASME Code

FRAME PLATE (FIXED)

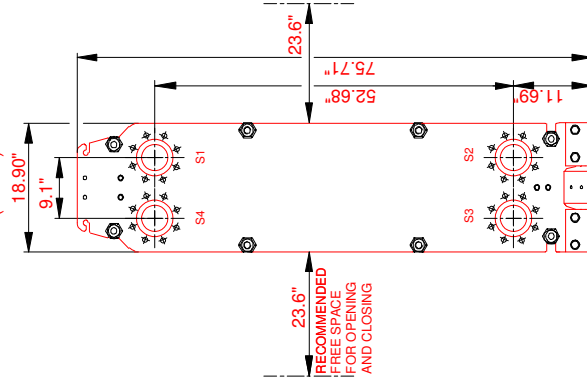

PRESSURE PLATE (MOVABLE)

SECTION A-A
PP = 1.575"



REMARKS:	SIDE 1	SIDE 2
DESIGN PRESSURE	150 psi	150 psi
TEST PRESSURE	195 psi	195 psi
MAX TEMPERATURE		
MIN TEMPERATURE	32 °F	32 °F
MAWP	150 psi	150 psi
MDMT		

GASKET	NBRB Clip-on
PLATE MATERIAL	ALLOY 304
PLATE THICKNESS	0.40 mm
WEIGHT WITH WATER	2692 lb
NETWEIGHT	2263 lb

THIS SPACE SHOULD BE KEPT FREE FROM FIXED INSTALLATIONS

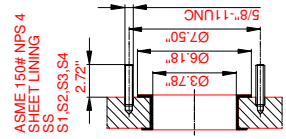
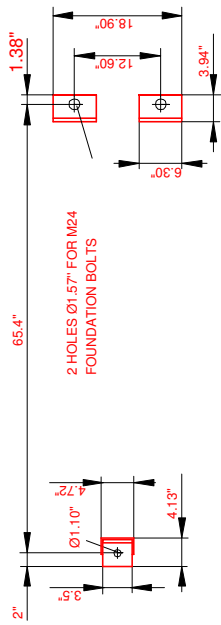

TOTAL LENGTH	68.7"
TOTAL WIDTH	18.9"
TOTAL HEIGHT	75.7"

PRESSURE DROP	
LIQUID VOL.	3.454 ft³
	3.454 ft³

Do not use this drawing for foundation bolting or piping layout.

ALL DIMENSIONS IN INCHES

SIDE		MEDIA	INLET	TEMP.	OUTLET	TEMP.	FLOW RATE	PRESSURE DROP	LIQUID VOL.
1			S1		S2				3.454 ft³
2			S3		S4				3.454 ft³

SUPPLIER	REF.	ITEM NO.
		AQ4L Medium
AGENT / REF.		
CUSTOMER NAME / REF. NO.		
SIGN.		RISK CATEGORY
		N/A

PLATE HEAT EXCHANGER

AQ4L-FG

ASME

QUOTATION

DATE

REV NO. 0