

Note that all unique customer requirements (i.e tolerance) need to be verified thru Alfa Laval.

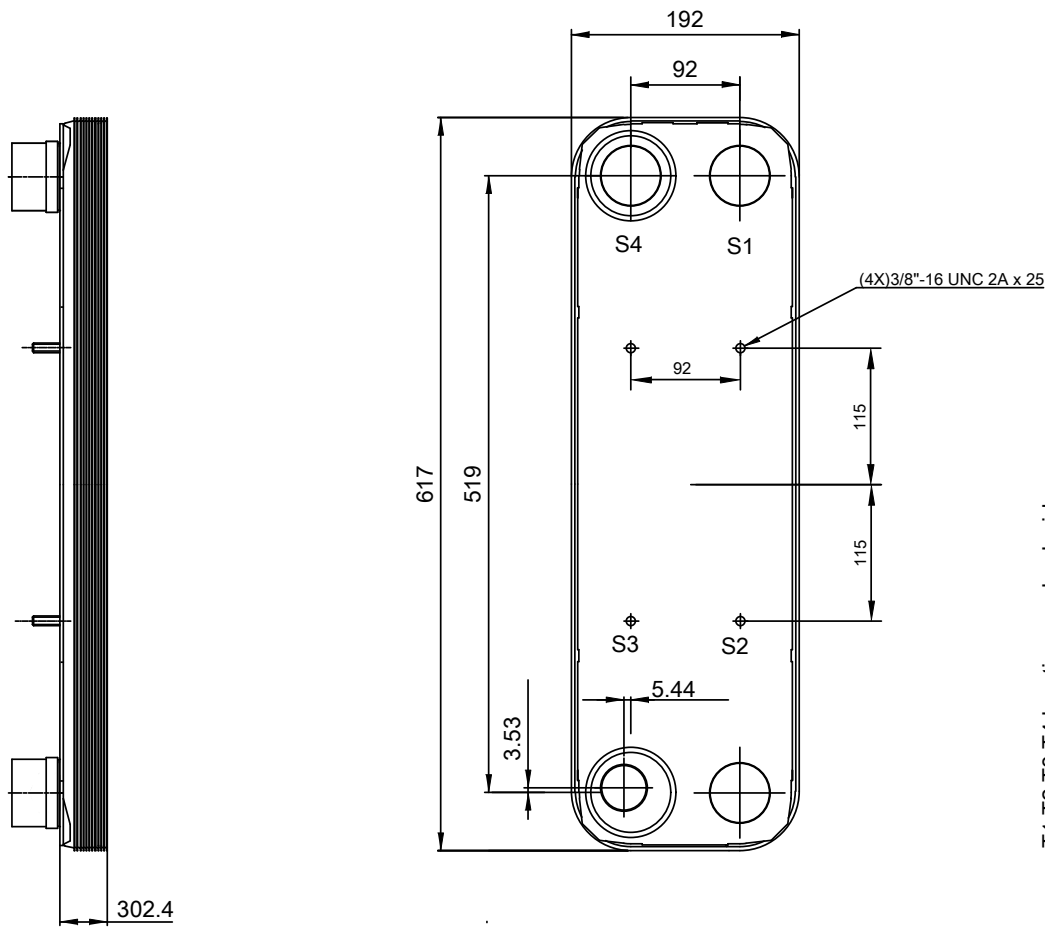
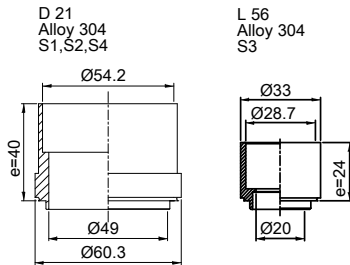

HEATING SURFACE
 NETWEIGHT 63.5 kg
 OPERATING WEIGHT
 PLATE MATERIAL Alloy 316
 PLATE GROUPING 1*61H/1*62H

T1 T2 T3 T4 locations on back side
 correspond to S1 S2 S3 S4 on front side

ALL DIMENSIONS IN MILLIMETERS

| SIDE | MEDIA | INLET | TEMP. | OUTLET | TEMP. | FLOW RATE | PRESSURE DROP | LIQUID VOL. |
|------|-------|-------|-------|--------|-------|-----------|---------------|----------------------|
| 1 | | | | | | | | 12.8 dm ³ |
| 2 | | | | | | | | 13.0 dm ³ |

PRESSURE VESSEL APPROVAL UL

ACH-120EQ-124H S62 (3287083736)

www.alfalaval.com

CUSTOMER NAME / REF. NO.

TOTAL LENGTH 342.4 mm
 TOTAL WIDTH 192.0 mm
 TOTAL HEIGHT 617.0 mm

COMPANY / REF.

9/13/2017
 REV 0