

T1 T2 T3.1 T3.2 T4.1 T4.2 locations on back side correspond to S1 S2 S3.1 S3.2 S4.1 S4.2 on front side

Note that all unique customer requirements (i.e tolerance) need to be verified thru Alfa Laval.

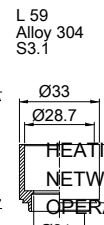

HEATING SURFACE 45.9 kg  
 NET WEIGHT  
 OPERATING WEIGHT Alloy 316  
 PLATE MATERIAL  
 PLATE GROUPING 1\*50HR/1\*51HB

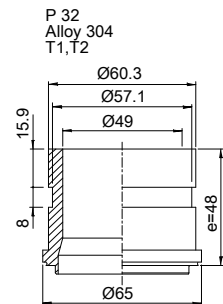
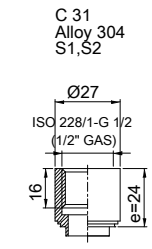
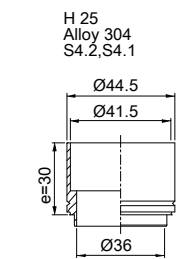
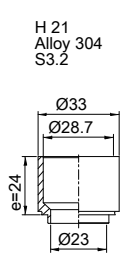
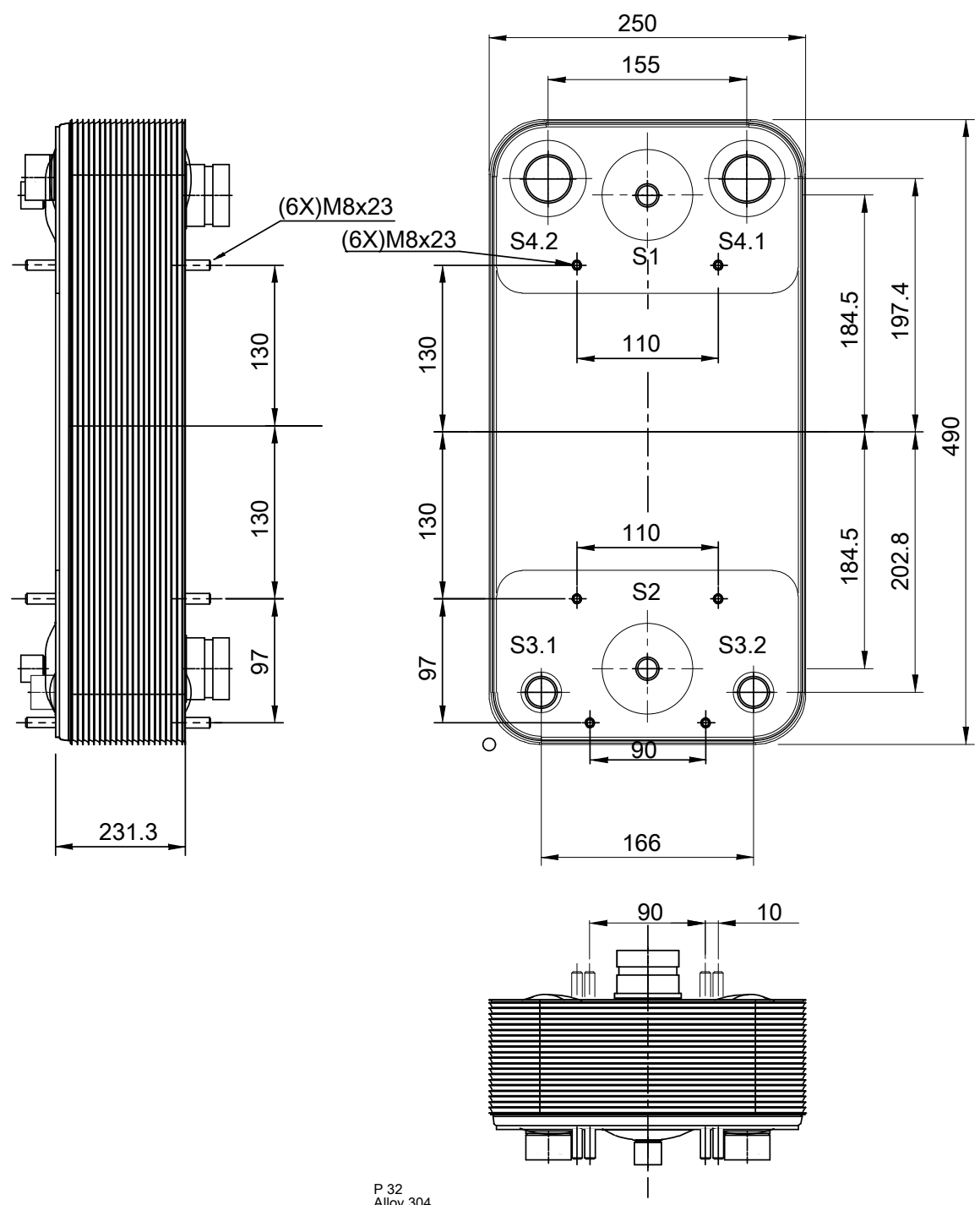

ALL DIMENSIONS IN MILLIMETERS

SIDE	MEDIA	INLET	TEMP.	OUTLET	TEMP.	FLOW RATE	PRESSURE DROP	LIQUID VOL.
1								5 dm <sup>3</sup>
2								5/5 dm <sup>3</sup>



PRESSURE VESSEL APPROVAL PED  
 ACH-230DQ-102H-F (3287069867)

www.alfalaval.com

CUSTOMER NAME / REF. NO.  
 COMPANY / REF.

TOTAL LENGTH 307.3 mm  
 TOTAL WIDTH 250.0 mm  
 TOTAL HEIGHT 490.0 mm

3/24/2017  
 REV 0

