

Note that all unique customer requirements (i.e tolerance) need to be verified thru Alfa Laval.

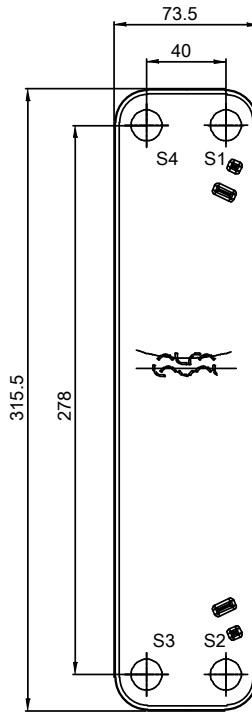

T1 T2 T3 T4 locations on back side correspond to S1 S2 S3 S4 on front side

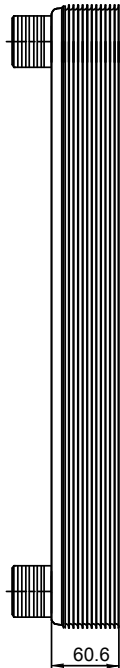
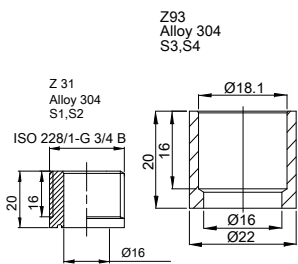
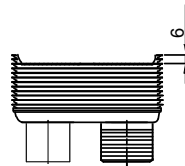

HEATING SURFACE  
 NETWEIGHT 2.25 kg  
 OPERATING WEIGHT  
 PLATE MATERIAL Alloy 316  
 PLATE GROUPING 1\*11H/1\*12H

ALL DIMENSIONS IN MILLIMETERS

SIDE	MEDIA	INLET	TEMP.	OUTLET	TEMP.	FLOW RATE	PRESSURE DROP	LIQUID VOL.
1								0.42 dm <sup>3</sup>
2								0.45 dm <sup>3</sup>

PRESSURE VESSEL APPROVAL PED

ACH18-24H-F (3287160208)

[www.alfalaval.com](http://www.alfalaval.com)

CUSTOMER NAME / REF. NO.

TOTAL LENGTH 80.6 mm  
 TOTAL WIDTH 73.5 mm  
 TOTAL HEIGHT 315.5 mm

COMPANY / REF.

3/9/2017  
 REV 0