

Note that all unique customer requirements (i.e tolerance) need to be verified thru Alfa Laval.

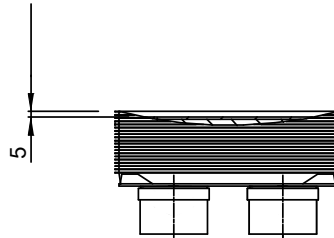
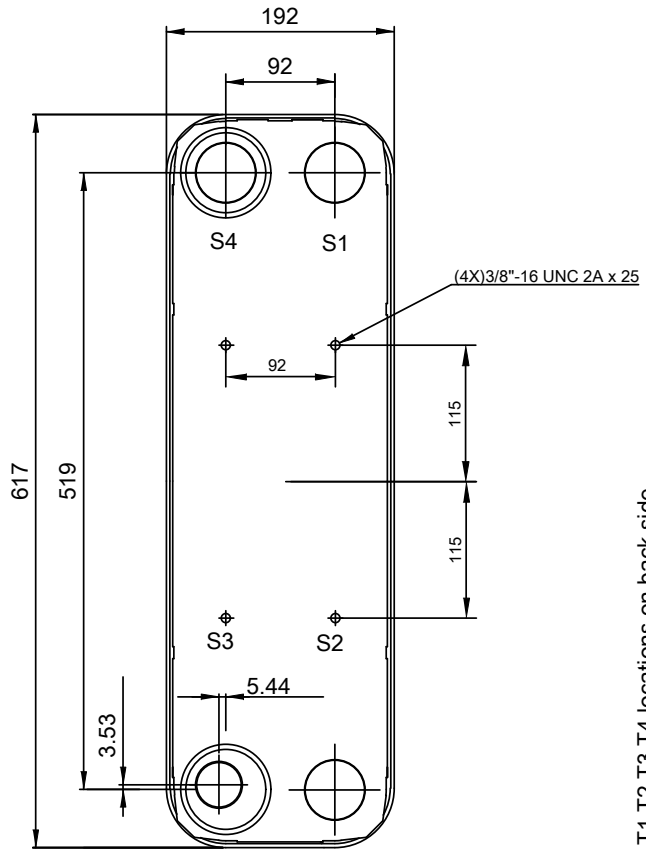
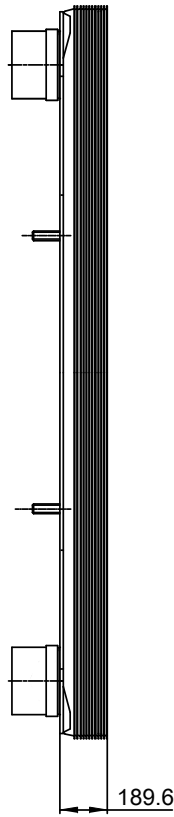
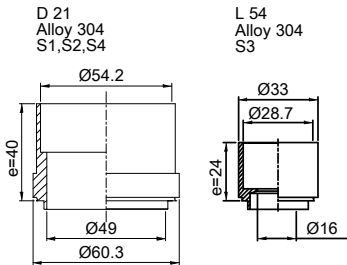

HEATING SURFACE  
 NETWEIGHT 42.3 kg  
 OPERATING WEIGHT  
 PLATE MATERIAL Alloy 316  
 PLATE GROUPING 1\*37H/1\*38H

T1 T2 T3 T4 locations on back side  
 correspond to S1 S2 S3 S4 on front side

ALL DIMENSIONS IN MILLIMETERS

| SIDE | MEDIA | INLET | TEMP. | OUTLET | TEMP. | FLOW RATE | PRESSURE DROP | LIQUID VOL.          |
|------|-------|-------|-------|--------|-------|-----------|---------------|----------------------|
| 1    |       |       |       |        |       |           |               | 7.77 dm <sup>3</sup> |
| 2    |       |       |       |        |       |           |               | 7.98 dm <sup>3</sup> |

PRESSURE VESSEL APPROVAL UL

ACH-120EQ-76H S62 (3287083733)

www.alfalaval.com

CUSTOMER NAME / REF. NO.

TOTAL LENGTH 229.6 mm  
 TOTAL WIDTH 192.0 mm  
 TOTAL HEIGHT 617.0 mm

COMPANY / REF.

9/13/2017  
 REV 0